

Voilà

True 2" Cylinder Pendant

LUMENWERX

Project: _____

Type: _____



Aperture Size

2"

Baffle Position



Flush, 1/2" & 1" regress baffles

Height

4.5", 6", 9"

Mounting Types

Pendant

Cylinder & Cuboid Finishes

- Textured matte white
- Textured matte black
- Custom RAL

Color Temperatures

- 2700K
- 3000K
- 3500K
- 4000K
- SOLA
- DUO

Delivered 529-1338 lm
7-14 Watts, up to 128 lm/W

Integral Drivers

0-10V, TRIAC & ELV

Remote Drivers

0-10V, TRIAC & ELV
eldoLED
Lutron
DMX
Remote emergency battery pack

Voilà 2" Cylinders feature innovative Hyflex™ optics for precise beam control. Voilà 2 "Cylinders are offered in round form factor, and in three height options, all with remote drivers. The Voilà COB source matches other Lumenwerx luminaires, with 90 CRI and 2-step color consistency, and is available in Chromawerx SOLA and DUO. Complete Voilà offering includes 2" and 4" apertures; downlights, adjustables, and wall washers; round and square trim; and cylinders.

Performance

LUMEN OUTPUT ¹	WATTS	EFFICACY LM/W
896 lm	7 W	128 lm/W
1103 lm	10 W	110 lm/W
1338 lm	14 W	96 lm/W

¹ Lumens packages are assuming 3500K, 80 CRI, 30° beam, round white baffle

Delivered Lumens for Round White Flush (IP) Baffles at 35K

CRI	90 CRI							
	10	20	30	40	50	60	75	90
BEAM								
Low - 7 W	496	487	822	795	785	730	684	656
Medium - 9.8 W	641	630	1012	978	966	898	841	807
High - 13.8 W	828	814	1228	1187	1173	1090	1021	980

Cylinder

Product Specification

LUMINAIRE ID	CYLINDER	BAFFLE		LENS	
VO2CYP					
VO2CYP - Voilà 2" Cylinder Pendant	HEIGHT 4.5 - 4.5" 6 - 6" 9 - 9"	FINISH TMW - Textured matte white TMB - Textured matte black CF# - Custom finish, specify RAL# (e.g. CF1028)	POSITION 1P - Flush 2P ¹² - ½" 3P ¹³ - 1" ¹ Only available with 50° beam or lower. ² Not available with 4.5" length. ³ Not available with 4.5" and 6" lengths.	FINISH TMW - Textured matte white TMB - Textured matte black CF# - Custom finish, specify RAL# (e.g. CF1028)	SDL - Soft diffused lens FDL - Frosted diffused lens NOL - No lens

Light Element

LIGHT SOURCE	BEAM	COLOR QUALITY	CRI	COLOR TEMP	OPTION
SW - Static white	10 - 10° Narrow spot 20 - 20° Spot 30 - 30° Narrow flood 40 - 40° Flood 50 - 50° Wide flood 60 - 60° Very wide flood 75 - 75° Very wide flood 90 - 90° Open flood	3 - 3 Step MacAdam Ellipse (For beam 10°&20°) 2 - 2 Step MacAdam Ellipse (For beam 30°-90°)	80 - 80 CRI 90 - 90 CRI 97 ⁶ - 97 CRI ⁶ Not available with 3500K.	27 - 2700K 30 - 3000K 35 - 3500K 40 - 4000K	HEX - Hex louver NA - None
SOLA - Dim-to-warm DUO - Tunable white	20 ⁴ - 20° Spot 40 ⁵ - 40° Flood 50 ⁵ - 50° Wide flood 60 ⁵ - 60° Very wide flood 75 ⁵ - 75° Very wide flood 90 ⁵ - 90° Open flood ⁴ Available with low output only. ⁵ Available with high output only.	3 - 3 Step MacAdam Ellipse	90 - 90 CRI (SOLA and DUO)	SOLA - Dim-to-warm 35K-22K DUO - Tunable white 27K-65K	

Power Supply & Dimming

VOLTAGE	WATTAGE (80 CRI) ⁸	DIMMING	
120 - 120V UNV - 120V-277V 347 ⁷ - 347V ⁷ Available with remote 0-10V dimming options RD1 and RSD1 only. Consult factory for details.	7W - Low output 529-896 lm 10W - Medium output 683-1103 lm 14W - High output 883-1338 lm ⁸ For delivered lumens, see multiplier tables on page 3.	INTEGRAL D1 - 1% 0-10V ELV ⁹ - ELV 120V TRI ⁹ - TRIAC 120V ⁹ Available with 120V only.	REMOTE RD1 - 1% 0-10V RELV ¹⁰ - ELV 120V RTRI ¹⁰ - TRIAC 120V RLTEA2W ¹⁰¹¹ - Lutron 1% - 2 wire FP 120V RLDE1 - Lutron Hi-lume 1% Eco RLDES - Lutron 5% EcoSystem RDA - DALI RELD0 - eldoLED 0.1% RELD1 - eldoLED 1% ¹⁰ Available with 120V only. ¹¹ Not available with 7W.
	SOLA 8W - Low output 560 lm (20° only) 13W - High output 740-900 lm (40° and up) DUO 5W - Low output 300 lm (20° only) 10W - High output 530-640 lm (40° and up)	SOLA SDI - Single 0-10V input	SOLA RSD1 - Single 0-10V input DUO RDMX - DMX, to specify, see pages 6 to 8 RDDA - DALI RDD1 - Dual 0-10V input for CCT/intensity RPSQ0 - Lutron T-Series 1% tunable white

Mounting

CANOPY	HANGER		
TYPE REG - Regular canopy, 4" octagonal junction box, round canopy (remote driver only) INT - Integral driver on junction box, round canopy (integral driver only) CD - Conduit feed, round canopy (remote driver only)	FINISH TMW - Textured matte white TMB - Textured matte black CF# - Custom finish, specify RAL# (e.g. CF1028)	POWER CORD BPC##IN - Black PVC WPC##IN - White PVC FRE##IN ¹³¹⁴ - Red fabric FGR##IN ¹³¹⁴ - Green fabric FBL##IN ¹³¹⁴ - Blue fabric Min 18" - max 72" Please specify length (##) in inches. ¹³ Not available with SOLA or DUO. ¹⁴ Consult factory for other fabric color options.	STEM BKS##IN - Textured black stem WHS##IN - Textured white stem Min 18" - max 48" Please specify length (##) in inches.

Photometrics

Please follow the multiplier tables to ensure correct lumen value. Beams, baffle color, lensing, CCT, CRI, baffle shape, baffle depth and accessories will change the lumen value.

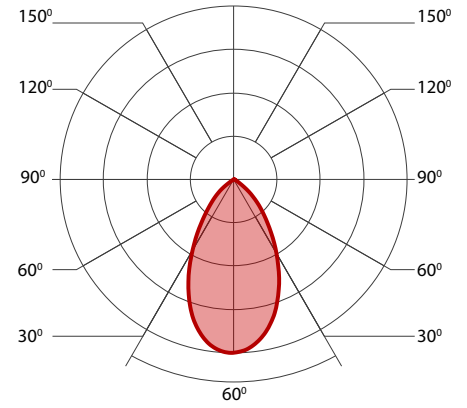
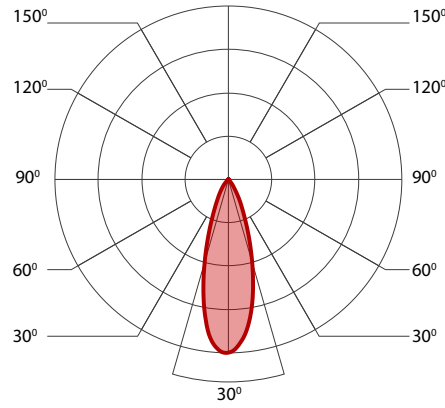
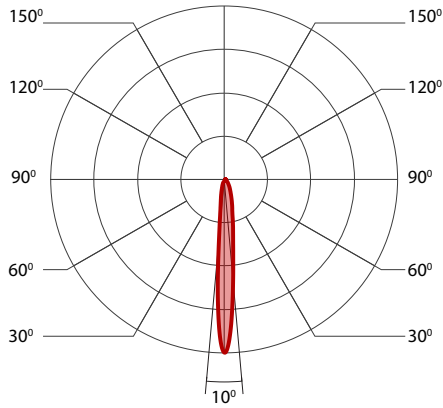

Delivered Lumens for Round White Flush (1P) Baffles - At 35K

BEAM	80 CRI								90 CRI							
	10	20	30	40	50	60	75	90	10	20	30	40	50	60	75	90
Low - 7 W	537	529	896	869	859	795	748	711	496	487	822	795	785	730	684	656
Medium - 9.8 W	694	683	1103	1068	1057	978	921	876	641	630	1012	978	966	898	841	807
High - 13.8 W	897	883	1338	1297	1283	1187	1118	1062	828	814	1228	1187	1173	1090	1021	980

Delivered Lumens - At 30K

97 CRI							
10	20	30	40	50	60	75	90
NA	NA	607	588	675	628	589	564
NA	NA	870	841	830	771	724	695
NA	NA	1056	1021	1009	937	878	855

Efficacy Based on Delivered Lumens - High 13.8 W

BEAM	LPW								
	10	20	30	40	50	60	75	90	
80 CRI		65	64	97	94	93	86	81	77
90 CRI		60	59	89	86	85	79	74	71
97 CRI		NA	NA	77	74	73	68	64	61

Beam Angle

BAFFLE POSITION	ACTUAL BEAM ANGLE							
	10	20	30	40	50	60	75	90
2" Cylinder Flush	10.4	19.1	32.0	40.0	46.5	59.0	73.1	80.1
2" Cylinder Regressed 1/2"	10.4	19.1	31.6	38.7	45.0	55.3	69.9	75.1
2" Cylinder Regressed 1"	10.4	19.0	30.2	36.6	42.0	50.9	62.8	67.7

Multiplier - Efficacy

BAFFLE POSITION	10	20	30	40	50	60	75	90
2" Cylinder Flush	1	1	1	1	1	1	1	1
2" Cylinder Regressed 1/2"	0.97	0.97	0.98	0.97	0.96	0.96	0.94	0.94
2" Cylinder Regressed 1"	0.93	0.93	0.94	0.92	0.91	0.89	0.87	0.85

SOLA and DUO Max Wattage

90CRI								
BEAM	10	20	30	40	50	60	75	90
DUO	NA	5	NA	10	10	10	10	10
SOLA	NA	8	NA	13	13	13	13	13

Multiplier - CCT

CCT	
2700K	0.9
3000K	0.95
3500K	1
4000K	1.05

Multiplier - Baffle Color

BAFFLE VARIABLES		
White	Round	1
Black	Round	0.95

Multiplier - Optical Options

LENS AND LOUVERS	
No lens	1
Soft diffused lens	0.94
Frosted lens	0.78
Hex louver	0.82

For SOLA and DUO, please consult factory.

Project: _____

Type: _____

Technical Specification

DESCRIPTION Ø 2" cylinder with multiple height, output, color, and dimming options in a variety of standard or custom finishes.

CYLINDER

Die-cast and extruded aluminum.

Power Cord: Black and white PVC, red, green and blue fabric. 18" to 72" standard length.

Stem: Rigid stem 18" to 48" standard length

Canopy: Regular and conduit (when recessed wiring is not possible)

Finish: Powder coated paint, textured white & black matte. Custom colors also available (provide RAL #)

FIELD REPLACEABLE LIGHT ELEMENT

LED Module: Integral COB module. 90 CRI and 2 SDCM, Standard with options of 80 CRI, or 97 CRI. L80 > 60,000 hours

Light Output: From 529-1338 lumens

HyFlex™ Optics: Proprietary TIR/reflector with field interchangeable beam smoothing lenses.

Thermal Management: Cold-forged aluminum heat sink to maximize thermal dissipation.

BAFFLE

Die-cast aluminum.

Baffle position: Flush, ½" and 1" regress

CHROMAWERX SOLA (dim-to-warm) and DUO (tunable white). See page 5 for more information.

ELECTRICAL

Integral drivers: 0-10V, ELV, TRIAC

Remote drivers: 0-10V, ELV, TRIAC

Lutron EcoSystem, Lutron Hi-lume, DALI, eldoLED 0.1%, eldoLED 1%, DMX, Lutron T-Series (tunable white).

Emergency options: Bodine emergency battery back-up is installed remotely. For 7W or 10W fixtures, battery provides 6W of power. For 14W fixtures, battery provides 10W of power.

ENVIRONMENT Ambient temperature at fixture location shall be within 0°C/32°F - 25°C/77°F, indoor dry or damp as well as outdoor damp use (canopies or marquees).

LISTING cETLus listed to UL 1598 and CAN/CSA Standard C22.2 No. 250.0

WARRANTY 5 year limited warranty on LED module and power supply. Guaranteed to maintain 70% lumen maintenance.

Light

Mounting

Stem Min 18" - Max 48"

PVC Power Cord¹ - Black, White

Fabric Covered Power Cord¹ - Red, Green, Blue

¹ Min 18" - Max 72"

Cylinder Housing

4.5", 6", 9" Height

Textured Matte White Finish

Textured Matte Black Finish

Custom Finish Specify RAL#

Light Element

Heat Sink

LED Module

Hyflex™ Optics

8 Available Beam Options

10° -90°

Lens

Frosted

Soft Diffused

Baffle

3 Baffle Positions - Flush, ½", and 1"

Textured Matte White Finish

Textured Matte Black Finish

Custom Finish Specify RAL#

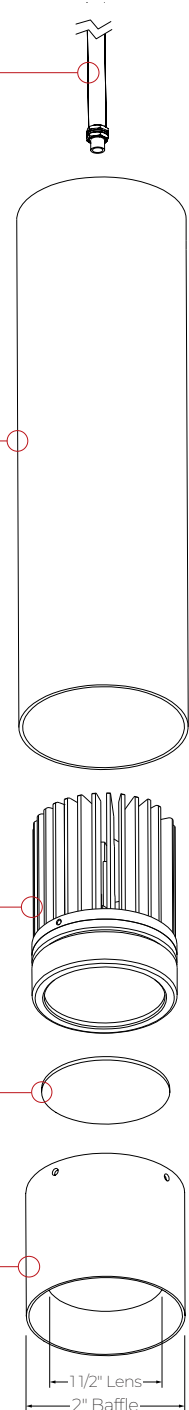

Voilà

True 2" Cylinder Pendant

LUMENWERX

Project: _____

Type: _____

Mounting

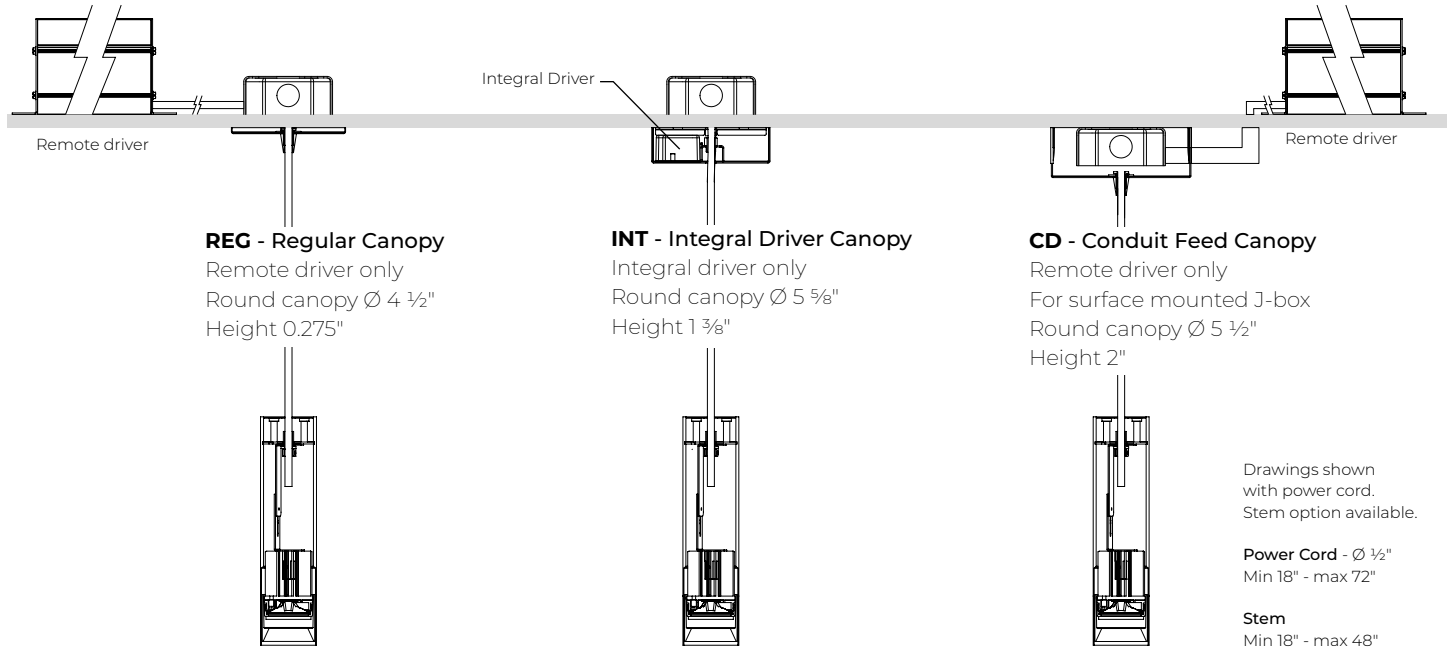

Optics

Hyflex™ optics provide precise optical control in a remarkably compact form.

The core of this four-tier system is compound reflector with a central TIR element, just 1.06" deep.

Beam-smoothing discs perfect beam angles up to 90°. Beam angles are easily interchanged in the field.

Light Source - LED

Compact COB (Chip-On-Board) LED module, available in 2700K, 3000K, 3500K and 4000K with a choice of 80 CRI or 90 CRI with elevated R9 value (for 97 CRI, consult factory). Color consistency is maintained to within 2 SDCM. All LEDs have been tested in accordance with IESNA LM-80-08 and the results have shown L80 lumen maintenance greater than 60,000 hours. Absolute product photometry is measured and presented in accordance with IESNA LM-79, unless otherwise indicated.

Beam Angles

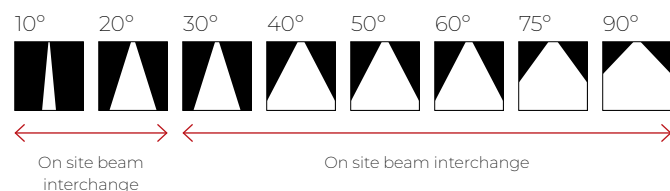

Chromawerx Sola is single-channel control that dims output while warming the color temperature in a pre-determined relationship. A simple or analog control adjusts a specially populated LED array to emulate the effect of dimming a filament source.



Chromawerx Duo offers a two-channel control system which uses analog or digital protocols for synchronous control of both warm (2700K) to cool (6500K) LED arrays - maintaining a CRI above 90. The range of color DUO offers is useful for entraining circadian rhythms, stimulating alertness, and compensating for jet lag among other applications. The Chromawerx drivers are programmed to limit maximum light output and power usage across all color temperatures.

DUO GENERIC DMX NETWORK ARCHITECTURE

A qualified DMX integrator is required to assure proper installation and commissioning of the DMX network. **When placing the PO, please provide the contact information of your DMX integrator.**

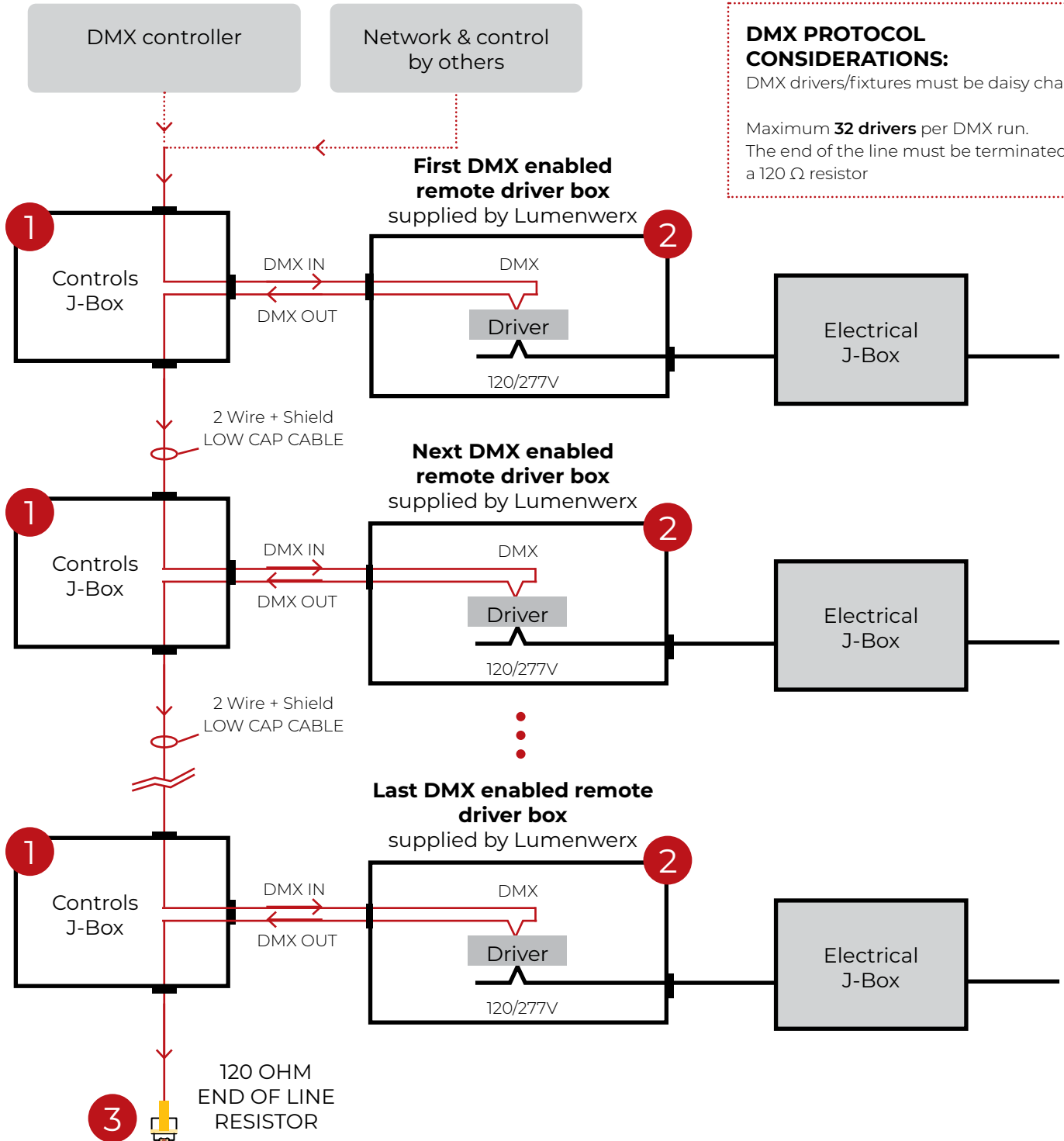

DMX PROTOCOL CONSIDERATIONS:
 DMX drivers/fixtures must be daisy chained.
 Maximum **32 drivers** per DMX run.
 The end of the line must be terminated by a 120 Ω resistor

1 J-BOX DMX DAISY CHAIN DETAIL

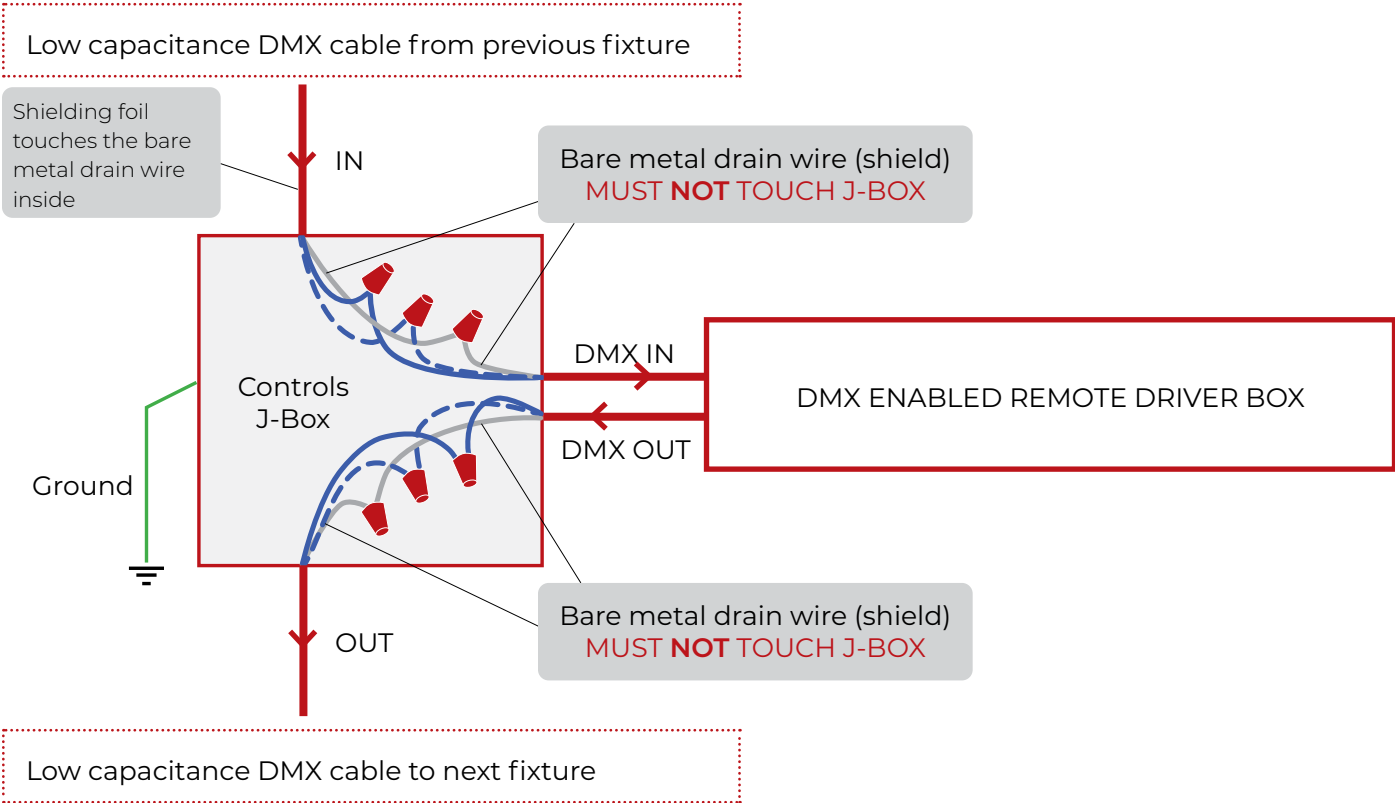

2 DMX CONNECTION REMOTE DRIVER

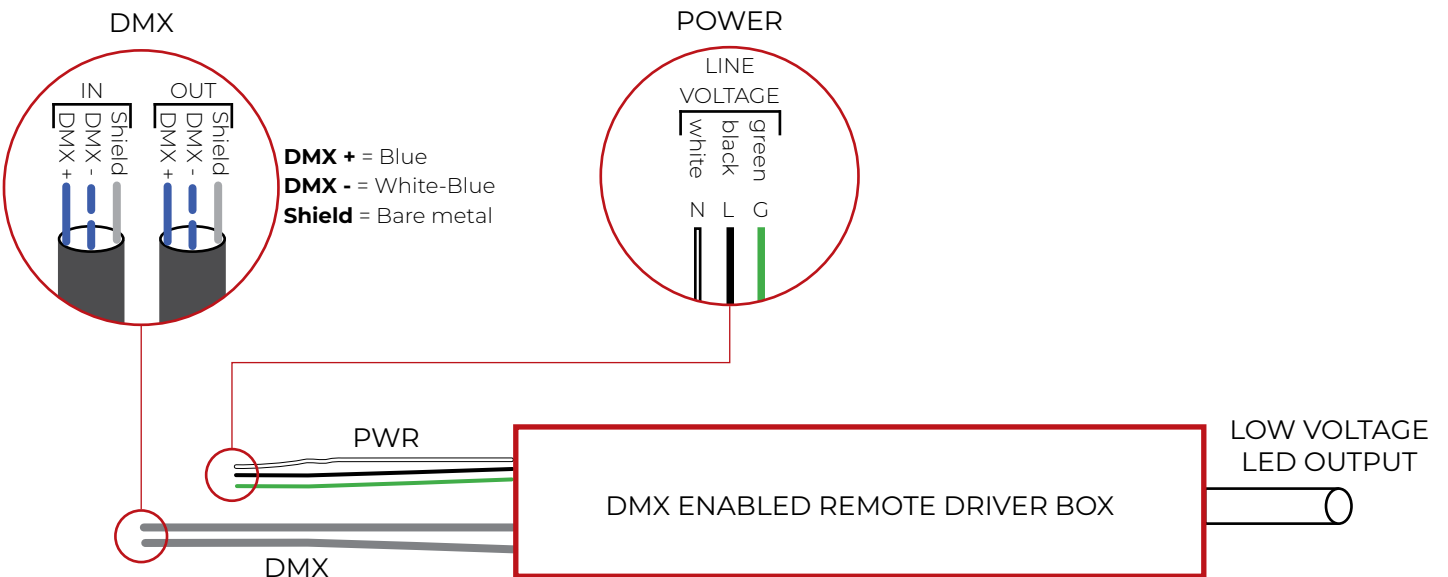

3 LAST DMX CONNECTION DETAIL

